

# RAM<sup>®</sup> Mounting Systems

PATENTED & PATENTS PENDING



**NPI has a Lifetime Warranty on all RAM Mounting Systems and a Limited Warranty on all electronic components. Detailed information regarding these warranties may be accessed on our web site at [www.ram-mount.com](http://www.ram-mount.com)**

## NPI<sup>®</sup>

National Products Inc.

Tel: (206) 763-8361 Fax: (206) 763-9615

Web Site: <http://www.ram-mount.com>

e-mail: [info@ram-mount.com](mailto:info@ram-mount.com)

RPR-182-CO2P-INS

# OWNERS MANUAL RAM<sup>®</sup> POWERED DOCKING CRADLE

PATENTED & PATENTS PENDING  
For iPAQ<sup>™</sup> Handheld Computers



## Charging/Serial Dock for iPAQ Handhelds

(For iPAQ 3100, 3600, 3700, 3800, 3900, 5400 & 5500 Series)

Provides constant charging and power for iPAQ electronic device in 12 to 28 Volt DC environments. Supplied wire harnesses allow for null or non-null modem cables. Includes fused coiled power cord with cigarette lighter plug and straight type power cord for hard wire applications (add to 2 Amp fused circuit only). Works with any brand or style expansion pack, plus the HP keyboard and all Navman GPS sleeves.

**PLEASE SEE IMPORTANT INSTRUCTIONS  
INSIDE BEFORE MOUNTING YOUR IPAQ !**

# CONTENTS, DESCRIPTION & ASSEMBLY INSTRUCTIONS

Before proceeding with assembly of powered docking cradle, check the contents of package to make certain all parts are included. If any parts are missing, please contact NPI for a replacement part at: [support@ram-mount.com](mailto:support@ram-mount.com)

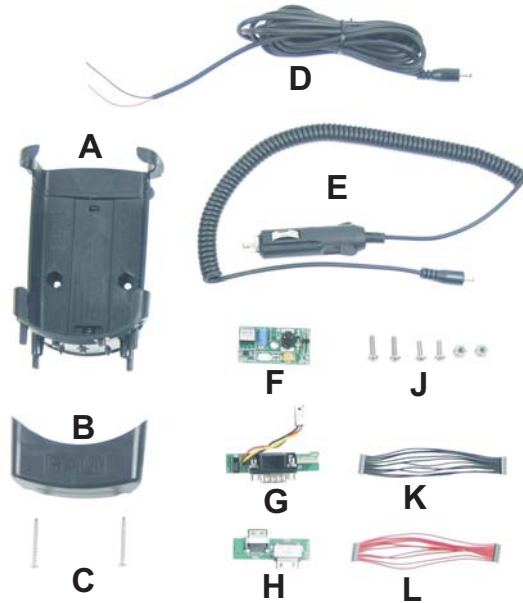

- A. 1 qty. RAM Main Plastic Housing
- B. 1 qty. RAM PCB Plastic Cover
- C. 2 qty. #8 X 1" Long Screws
- D. 1 qty. 10' Long Power Cord
- E. 1 qty. 10' Long Coiled Power Cord With Cigarette Plug
- F. 1 qty. Power Printed Circuit Board
- G. 1 qty. Input / Output Printed Circuit Board
- H. 1 qty. IPAQ Male Connector Printed Circuit Board
- J. 2 qty. of ea. #8-32 X 5/8" & 1/2" Long Screws & #8 Nuts
- K. 1 qty. Non-Null Modem Wire Harness (BLACK)
- L. 1 qty. Null Modem Wire Harness (RED)

First determine what type of connection you require for the serial port. We offer 2 different wire harnesses, a non-null-modem (**K Black**) and null modem (**L Red**). To determine what type you require, contact the manufacturer of your electronic device that you are attaching to the powered docking cradle. Once determined, select the appropriate colored wire harness and attach it to the corresponding PCB's **G & H** as shown in the **STEP 1** photo. Note, the ends have different numbers of connectors so they can't be reversed. Attach the 10 qty. connector socket to the **G** PCB & the 11 qty. connector socket to the **H** PCB. Connect the 3 wire socket on the **G** PCB to the pins on the **F** PCB. Make certain that the label marked "TOP FACING" is toward you as shown in the **STEP 1** photo.

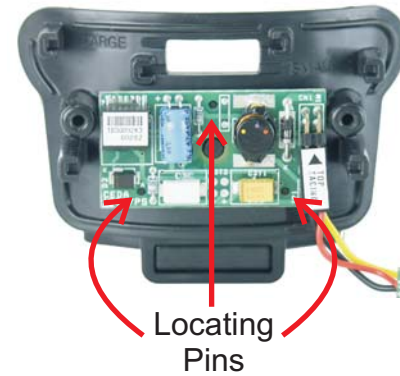
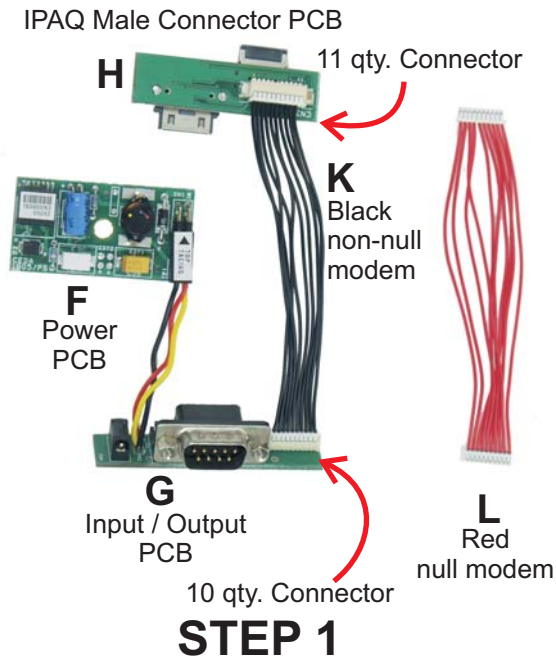

## STEP 2

Assemble power PCB (F) on the three corresponding pins on the housing (A) as shown in STEP 2 photo.

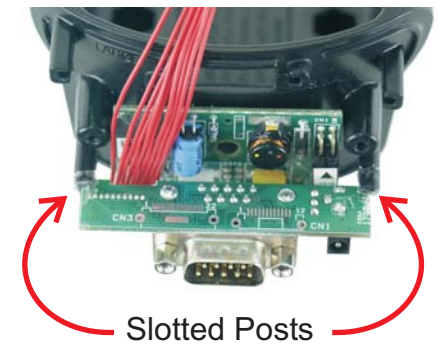

## STEP 3

Assemble Input / Output PCB (G) to the two slotted posts on housing (A) as shown in STEP 3 photo. Note: pre-bend the wire harness to aid in holding the PCB's in place and note the direction path of the wires.

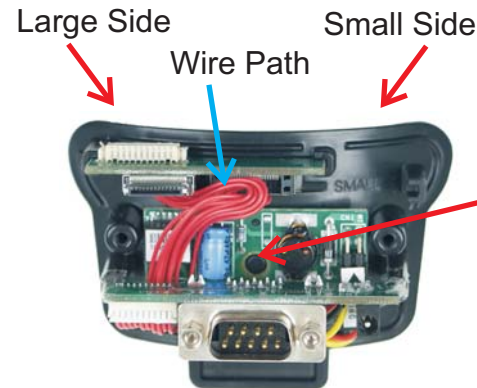

## STEP 4

The iPAQ Male PCB (H) has 2 different sized connectors. Before assembly, try the connector into your device to determine which one is to be used. Once that is determined, look on housing (A) to see the Small & Large lettering to indicate the side that the PCB will be on. Then assemble it as shown in STEP 4 photo. Note: pre-bend the wire harness to aid in holding the PCB's in place and note the direction path of the wires.



## STEP 5

Using a pointer, or similar device, insert it through the serial port hole in plastic cover (B) to aid in holding the PCB's in place while aligning and attaching the cover with the 2 screws (C). Gently snug the screws until the cover (B) touches housing (A).